



# GUILDED

FROZEN WELL ONLY INTEGRAL CABINET

# WALL INTEGRAL



## Benefits & Specifications:

- User-friendly
- Small footprint with compact design
- Easy access and ergonomic design
- Customized solutions for individual needs
- Fully configurable to different concepts
- Easily adaptable to seasonal needs
- Low operating costs
- Simplified maintenance
- Wide range of future refrigerant options



## Dimensions (mm):

Height : 1000  
 Length : 1250 (incl. side walls)  
 Depth : 1100

SYSTEM	OPERATING TEMP. °C	REFRIGERANT
PLUG-IN NEGATIVE	-22 / -24	HC HFC blend HFC / HFO blend

HC: R290 / R1270 • HFC: R407A / R407F / R404A • HFC / HFO: R448A / R449A / R452A

## TECHNICAL DATA

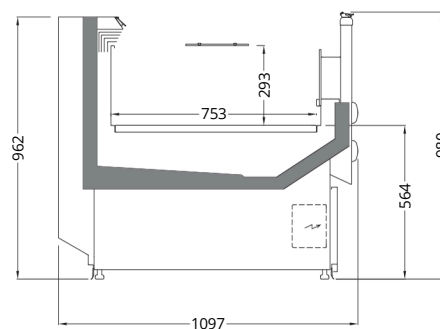
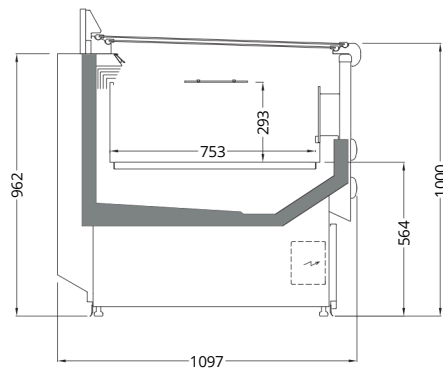

**GUILDED WALL INTEGRAL**

Length mm | 1250

# WHERE QUALITY MEETS RELIABILITY

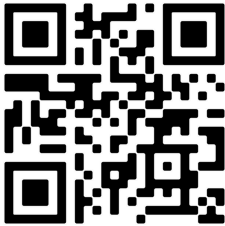
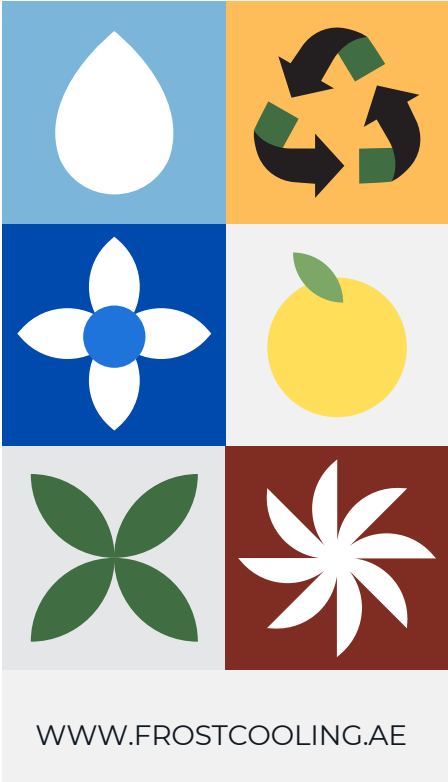

FROST COOLING TRADING  
SALES: +971 58 553 8232  
OFFICE: +971 58 520 5232  
EMAIL: SALES@FROSTCOOLING.AE